

Your Own Box

One of the first projects many beginning woodworkers build is a box to put things in. In this activity you'll need to decide the size and shape of the box you want to make. Who knows? After you learn to make a box your next project may be a birdhouse, tool chest or perhaps a bookcase.

Woodworking Skill: Using a crosscut or circular saw, try square, and gluing and nailing lumber together
Life Skill: Planning and organizing
Success Indicator: Builds a box
Tools Needed: Hammer, square, saw and pencil, sanding block
Materials Needed: 1" x 6" or 2" x 6" lumber, nails, sandpaper, hinges

Getting Started

You can make a box without being given exact dimensions. The size of the box you make is up to you. With a friend, family member or your woodworking helper begin by deciding the size you want the bottom of your box to be. The size of the bottom will tell you the size of the first side and the size of the first side will determine the size of the second side and so on. Directions to help you make your box are included in Woodworking Plans.

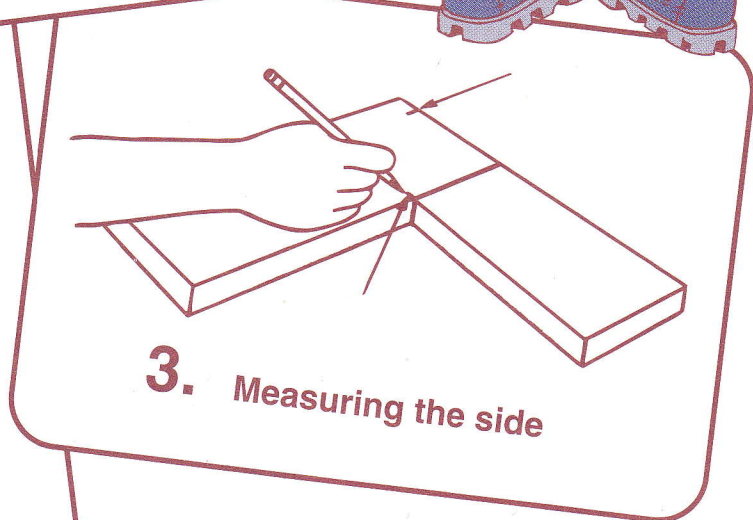
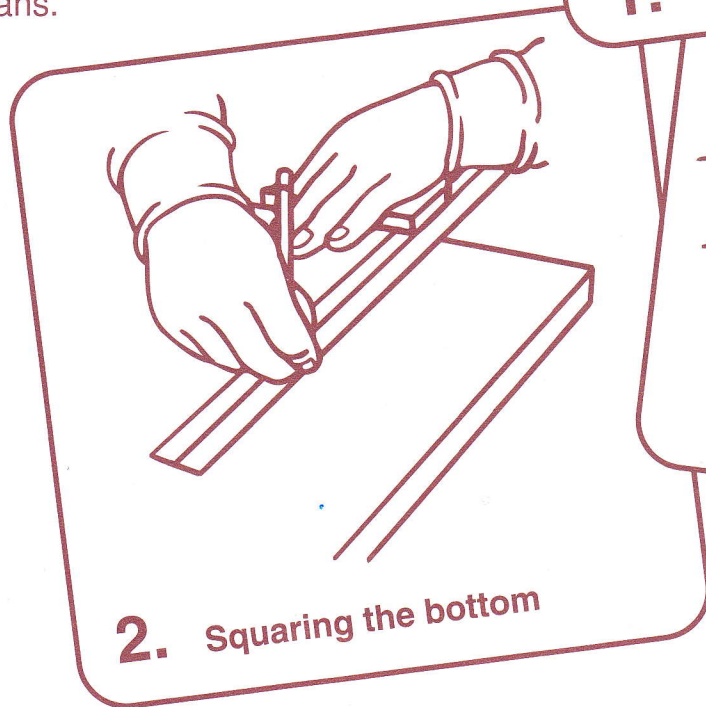
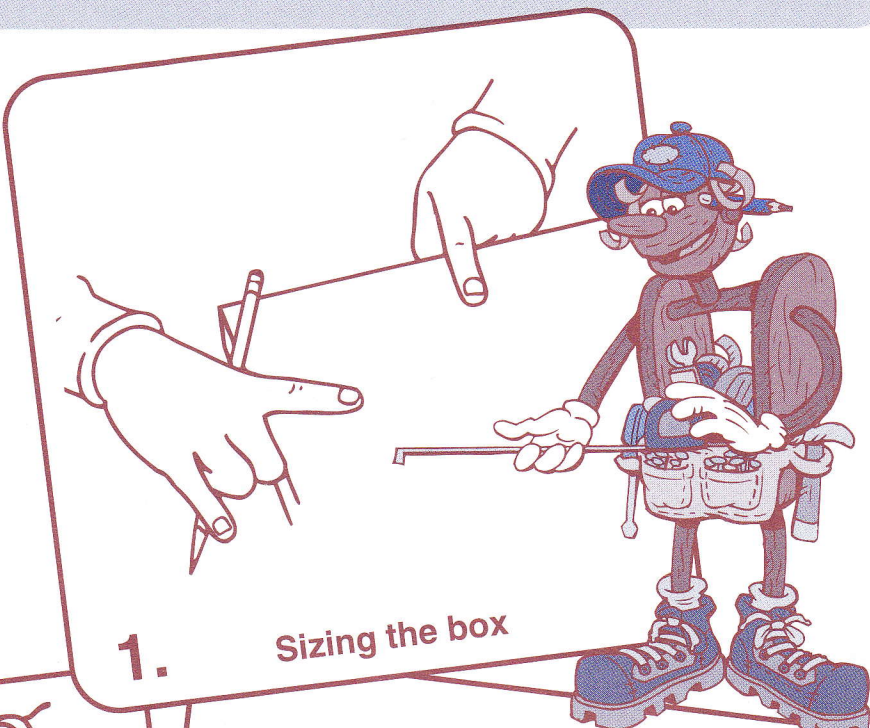

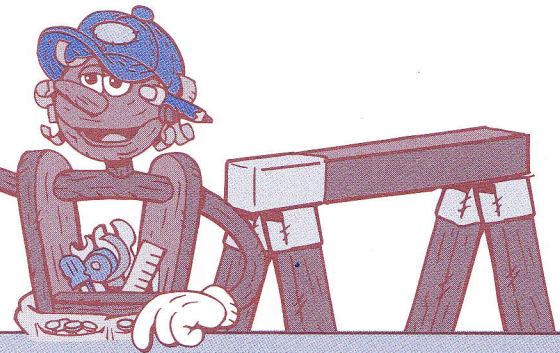
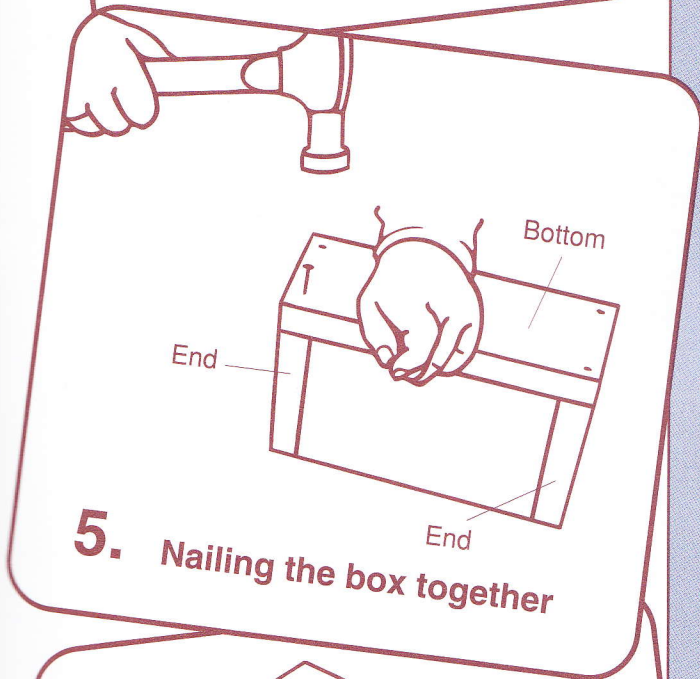
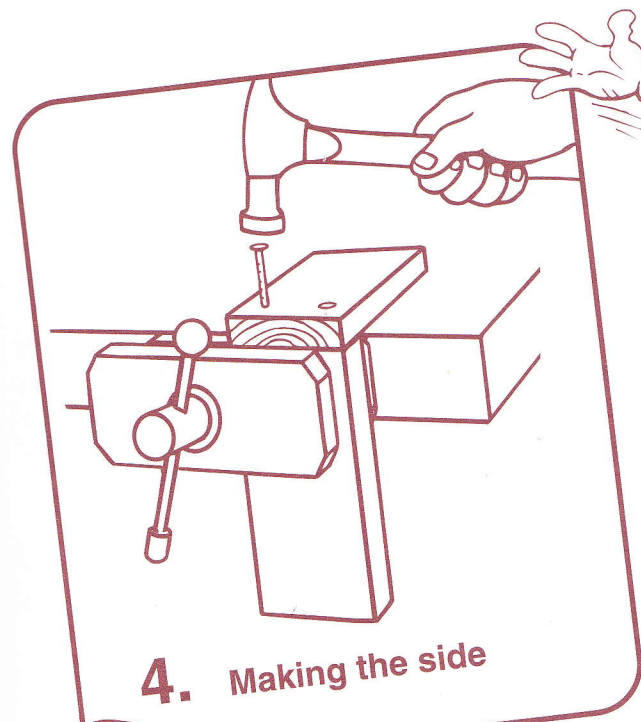

Plans

Building a Box

- Decide how big you want the bottom of your box to be. (Picture 1.) Mark the board and use a try square to draw the lines. (Picture 2.) Then saw the bottom.
- Make the ends of the box by holding the bottom against the corner of another board and mark its width. (Picture 3.)
- Decide how deep the box will be. Label the joint so it will be nailed together the right way.
- Lay out the rectangle with a square and saw out the first end.
- Glue and nail the end to the bottom. Hold the bottom of the box in a vise, spread a bead of glue on the end and nail it on with three or four nails. (Picture 4.)
- Mark the width of the other end of the box as you did the first one. Then mark the height of the second end using the first end as a pattern. Label the joint, square up the rectangle, cut out the end and nail it on the bottom. (Picture 5.)
- Use the bottom with the two ends nailed on to mark out the first side. Place one end of the box against the end of the board and line up the bottom with the adjacent edge. Trace the other three sides and saw it out.
- Glue and nail the side to all three edges of the box.
- Trace the other side of the box, saw it out and nail it on. Sand the box.
- You can also make a lid and add hinges to your box. (Picture 6.)