



# When Your Video Stage is the Great Outdoors

---



**Illinois Extension**

UNIVERSITY OF ILLINOIS URBANA-CHAMPAIGN

Trevor Pye via Unsplash





Curt Sinclair, 4-H Youth Development Extension Specialist, Shooting Sports, Environmental Education



Curt Sinclair, 4-H Youth Development Extension Specialist, Shooting Sports, Environmental Education

- Just Get Started
- Being Relaxed on Camera
- Shooting With a Crew of One



Curt Sinclair, 4-H Youth Development Extension Specialist, Shooting Sports, Environmental Education

- Just Get Started
- Being Relaxed on Camera
- Shooting with a crew of one



Heather Willis, Unit #26 Marketing and Communications Program Coordinator



Curt Sinclair, 4-H Youth Development Extension Specialist, Shooting Sports, Environmental Education

- Just Get Started
- Being Relaxed on Camera
- Shooting with a crew of one



Heather Willis, Unit #26 Marketing and Communications Program Coordinator

- Shooting with a “crew”
- Video logistics
  - Location
  - Noise Considerations
  - Sound Quality



# Just get started ...

---

- “Pitchfork Method”





# Just get started ...

---

- “Pitchfork Method”
- Everyone has a first shoot







# Being relaxed on camera

- Be Yourself



# Being relaxed on camera

A top-down photograph of a wooden surface, possibly a table, with horizontal wood grain. In the top-left corner, there is a small, round, lit candle in a dark container. In the center, a light blue rectangular sign is placed, featuring the words 'WORRY' and 'LESS' in bold, black, sans-serif capital letters, stacked vertically.

**WORRY  
LESS**

- Write Down Your Key Points





# Being relaxed on camera

- You Can Cut Stuff Out!



# Crew of One

- Equipment Set-Up



# Crew of One

- Vertical vs. Horizontal





# Crew of One

- Review your footage in the moment



# Crew of One

- Tips for aerial shoots

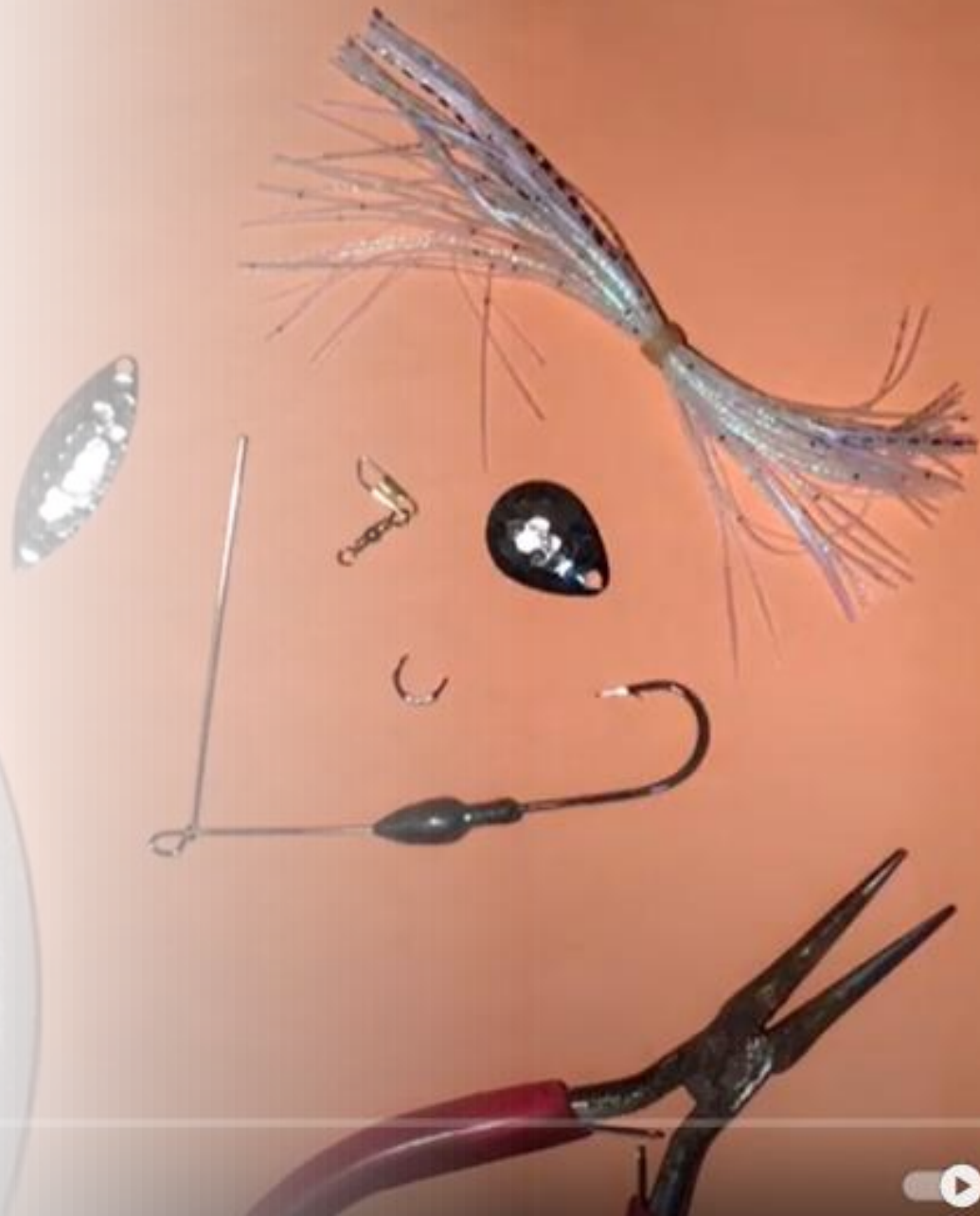





# Shooting With a Crew



# Location! Location! Location!

- Scout out a few locations.
- Look and listen.





Location!  
Location!  
Location!

- Have a backup plan.





# Location! Location! Location!

- Consider the lighting  
(*early morning vs.  
mid-day vs. late  
afternoon*)



# Noise Considerations

- Transportation  
*(trains, cars, buses)*
- Equipment  
*(road construction, lawn mowers, fans)*





# Noise Considerations

- Check the weather forecast
- Avoid rain or heavy wind
- [Example of heavy winds](#)
- [Repurpose footage](#)





# Sound Quality

- Face the camera and microphone.
- Speak loud and clear.
- Double-check the sound (mic batteries).



Photo by [israel palacio](#) on [Unsplash](#)



# Sound Quality

- Use a microphone wind muff.
- A sock can be used as a substitute.





# Sound quality

- Use voice recording app.
- Recording the audio separate.
- “Layer” audio in post-production.
- [Example](#)



Photo by [Soundtrap](#) on [Unsplash](#)



# Shooting with a “crew”

- Multiple cameras (varying views)
- Supplemental Lighting
- [Example](#)





# The Finishing Touches

# The Finishing Touches

- Getting the video from your phone or iPad to your computer



# The Finishing Touches

- Box is approved – desktop and iPad

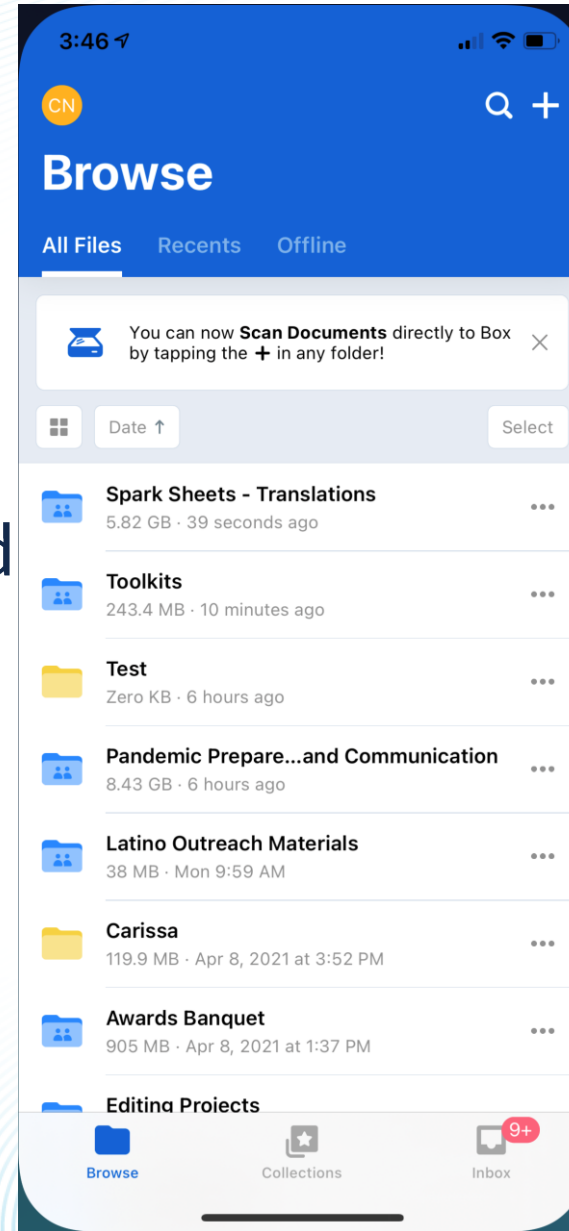

# The Finishing Touches

- Transfer from your iPad or phone and get it right on your desktop

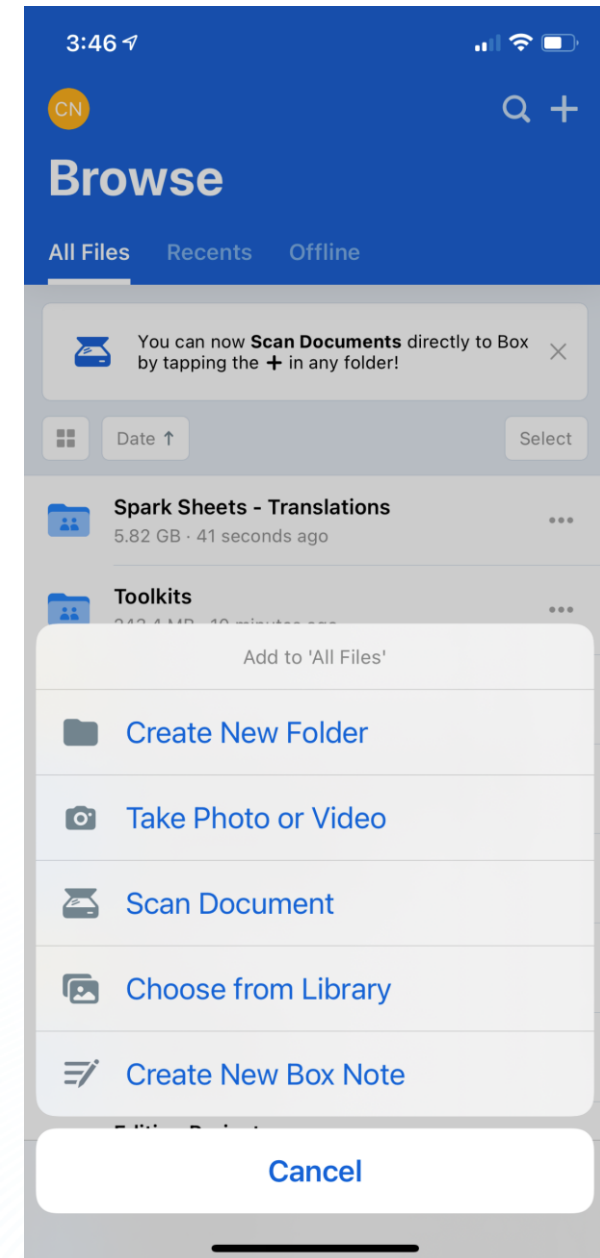
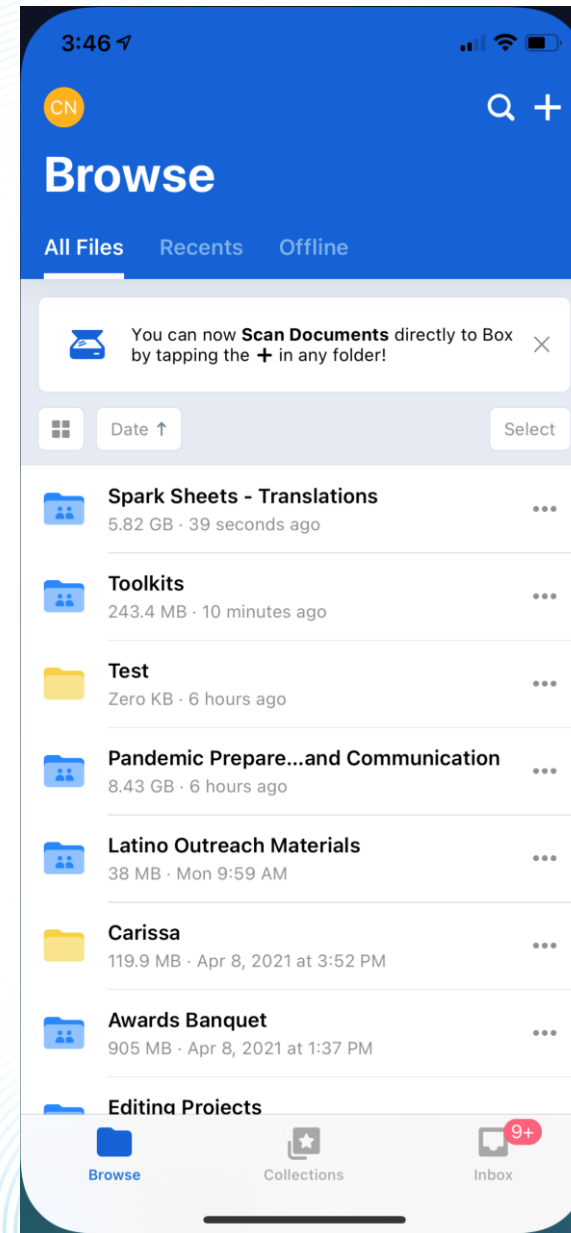



# The Finishing Touches

- Editing/Production



# The Finishing Touches

- Editing/Production
  - Outro Bumper





# The Finishing Touches

- What's the video approval process in your unit?



# The Finishing Touches

- Closed Captioning/Uploading
  - <https://extension.illinois.edu/commit/videos>





# Questions?

Photo by [NordWood Themes](#) on [Unsplash](#)



Carissa Nelson [carissa7@Illinois.edu](mailto:carissa7@Illinois.edu)

Curt Sinclair [sinclair@Illinois.edu](mailto:sinclair@Illinois.edu)

Heather Willis [hdwillis@Illinois.edu](mailto:hdwillis@Illinois.edu)

University of Illinois, U.S. Department of Agriculture, Local Extension Councils Cooperating. University of Illinois Extension provides equal opportunities in programs and employment. If you experience any problems accessing or receiving the information in this course, or have feedback on the design, please email [extension@illinois.edu](mailto:extension@illinois.edu) for assistance.

© Copyright 2020 University of Illinois Board of Trustees



**Illinois Extension**  
UNIVERSITY OF ILLINOIS URBANA-CHAMPAIGN